

**Stepper Paper Mask**

<b>Item #</b>	<b>Part #</b>	<b>Description</b>
1	368124	Stepper Paper Mask
2	368656	Stepping Motor Assy. - Stepper Mask
3	368557	Wire Harness - Stepper Paper Mask
4	371428	Mount - Mask, L.H.
5	706391	Pulley - Timing, .080 P., 24 T., .25 B., .25 Wide,
6	701491	Bearing - Ball, Flnged,.25 I.D., .50 O.D., .218 W
7	704457	Ring - Grip, .25 Dia. Shaft
8	706396	Belt - Timing, .080 P., 195 Teeth, 15.60 Pl,.25W
9	368145	Shaft - Drive
10	368138	Angle - Support
11	368146	Mask - Cloth, L.H.
12	368126	Plate - Mounting, Clamp, Mask
13	371437	Plate - Mounting, Clamp, Mask, w/ Flag
14	371436	Blade Wldmt - Mask, Left
15	368130	Slide - Masking, Left
16	371430	Brace - Rear
17	369142	Cover - Pulley and Screw (2 Pc.)
18	371429	Brace - Front
19	371433	Shaft - Pulley
20	371434	Pulley - Timing, 24 tooth
21	706892	Belt - Timing, .080 P. ,260 Teeth, 20.8 Pl,.25W
22	368323	Stiffener - Short
23	702633	Tape - Transfer, .50 Wide
24	368127	Clamp - Belt
25	371927	Strip - Anti-reflection
26	368322	Stiffener - Long
27	368321	Slide w/f - Mask, Right
28	706519	Anchor - Spring, 6-32 x .63l, .050 Hole
29	706400	Spring - Ext, .018WD, .180 O.D., 1.25FL, .7lb/in
30	706518	Spacer - Round, 6-32 I.D., .250 O.D., .125 L
31	368140	Plate Wldmt - Mask, Right
32	705303	Ring - Grip,.25
33	368131	Bracket Wldmt - Clamp, Belt, R.H.
34	706520	Bearing - Flanged, .191 I.D., .313 O.D., .25 W
35	371432	Tab - Sensor, Right
36	368320	Plate - Clamp, Belt, Right
37	706394	Belt - Timing, .080 P., 453 Teeth, 35.24 Pl,.25W
38	368336	Mount - Clamp, Belt, R.H.
39	368144	Shaft - Blade, Mask
40	706516	Screw - SHL, SK, .187Dia. x .625 L, 8-32, Blk
41	371427	Mount - Mask, R.H.
42	368658	Sensor Assy. - Optical
43	371431	Mount - Sensor
44	706393	Collar - Clamp, 2 piece, .25I.D., 62 O.D., .281W
45	368690	Bracket - Pulley
46	368765	Sensor Assy. - Optical w/Bracket & Flag Guide
47	368725	Controller Assy. - Stepper Paper Mask
48	368678	Cover - Stepper
49	706399	PCB Assy. - Controller, TR-51
50	368777	Program - Prom, Stepper Mask
51	368607	Wire Harness - Controller, Stepper Mask
52	702652	Module - Translator, Type 230-1
53	368681	Bracket - Board, Elec.
54	368679	Bracket - Mounting, Right
55	368680	Plate - Base, Stepper
56	368651	Bracket - Mounting, LH
57	320219	Cable - Power Supply
58	369071	Cable Adapter - "Y" (Accudata Controlled w/ existing 24VDC Power Supply Only)
59	368657	Wire Harness - Serial Cable
60	360277	Power Supply Assy. (Accudata Controlled Only)

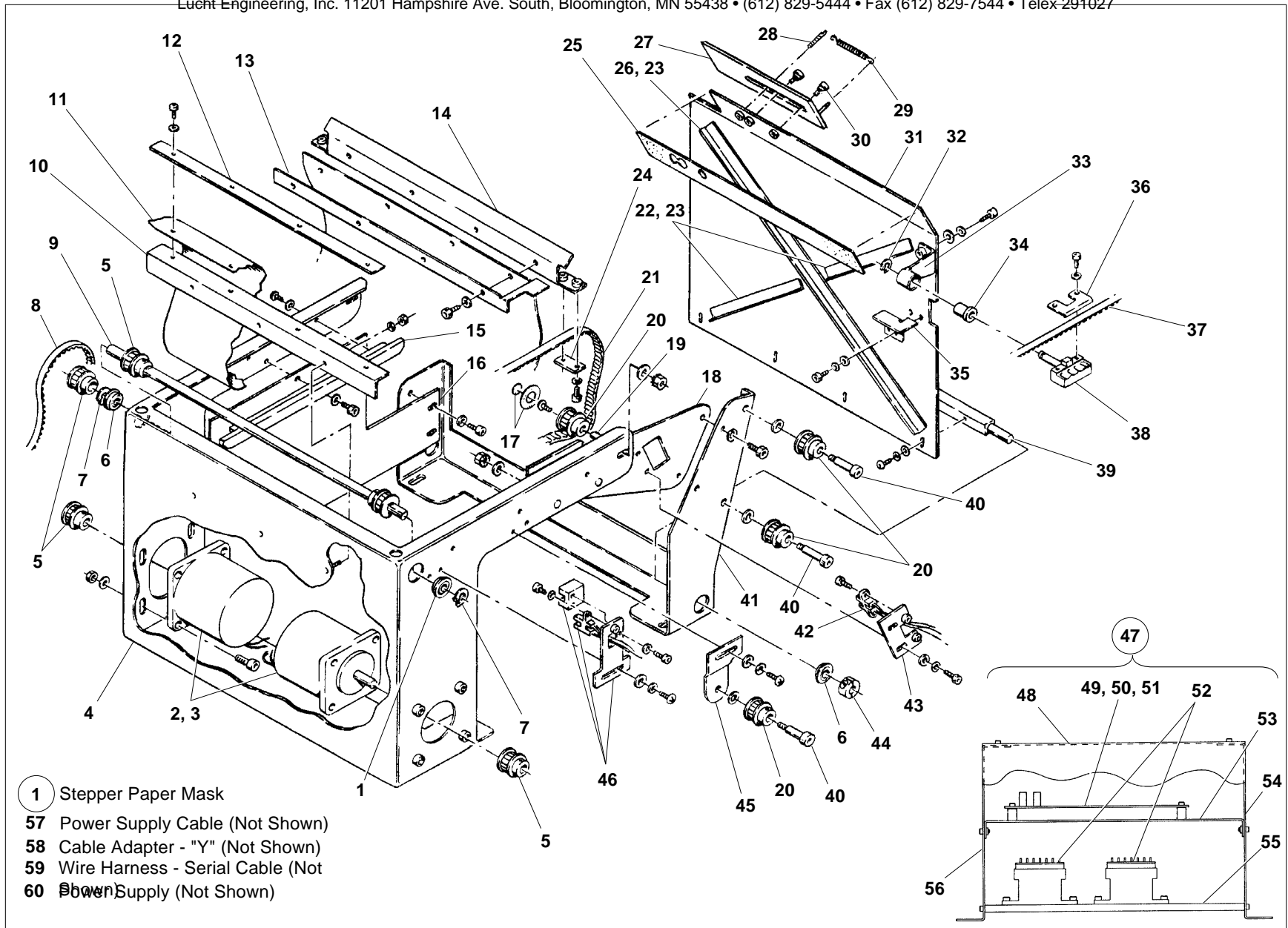

Figure 4 — Stepper Paper Mask