

Section 5 — Parts

These parts lists include the old five-digit Hamlin part numbers in parentheses. Please use the six-digit Lucht part numbers when ordering spare or replacement parts.

370564 / 01-003 5S Combination Punch Marker - Right-hand Mount

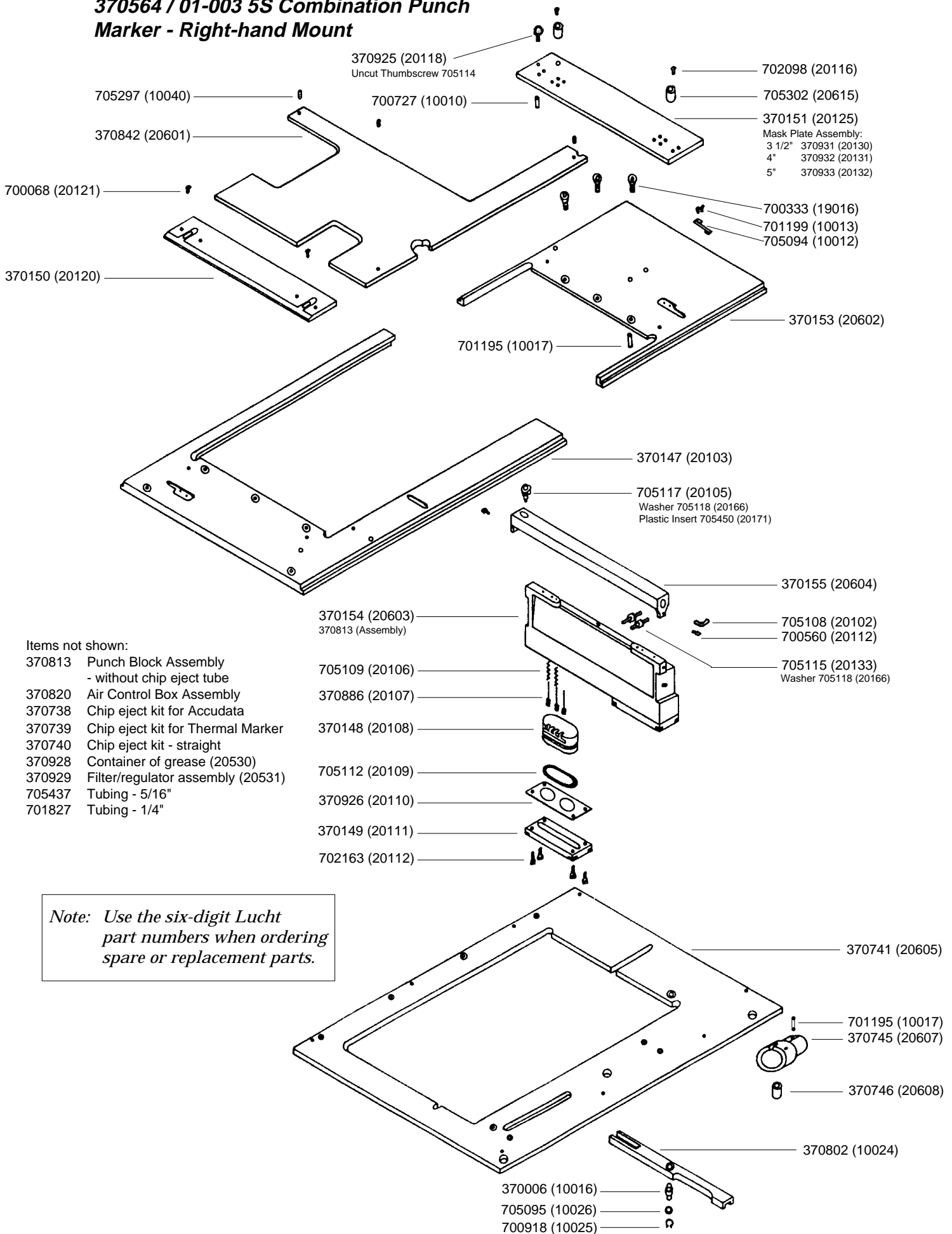

Note: Use the six-digit Lucht part numbers when ordering spare or replacement parts.

**370717 / 01-001 5S Combination Punch Marker -
Left-Hand Mount**

Note: Use the six-digit Lucht part numbers when ordering spare or replacement parts.

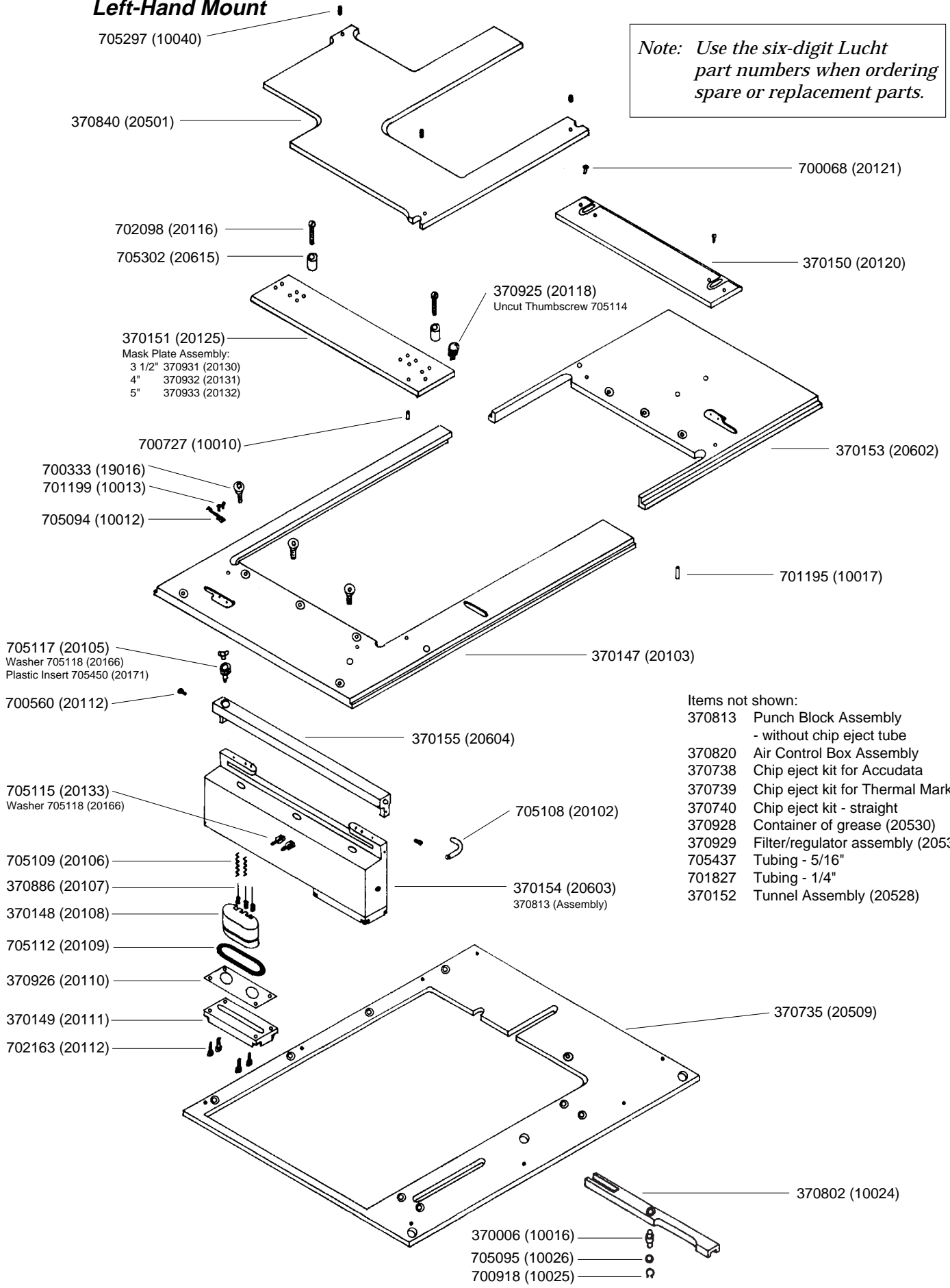

370718 / 01-012 5S 5" Punch Marker - Left-Hand Mount

Note: Use the six-digit Lucht part numbers when ordering spare or replacement parts.

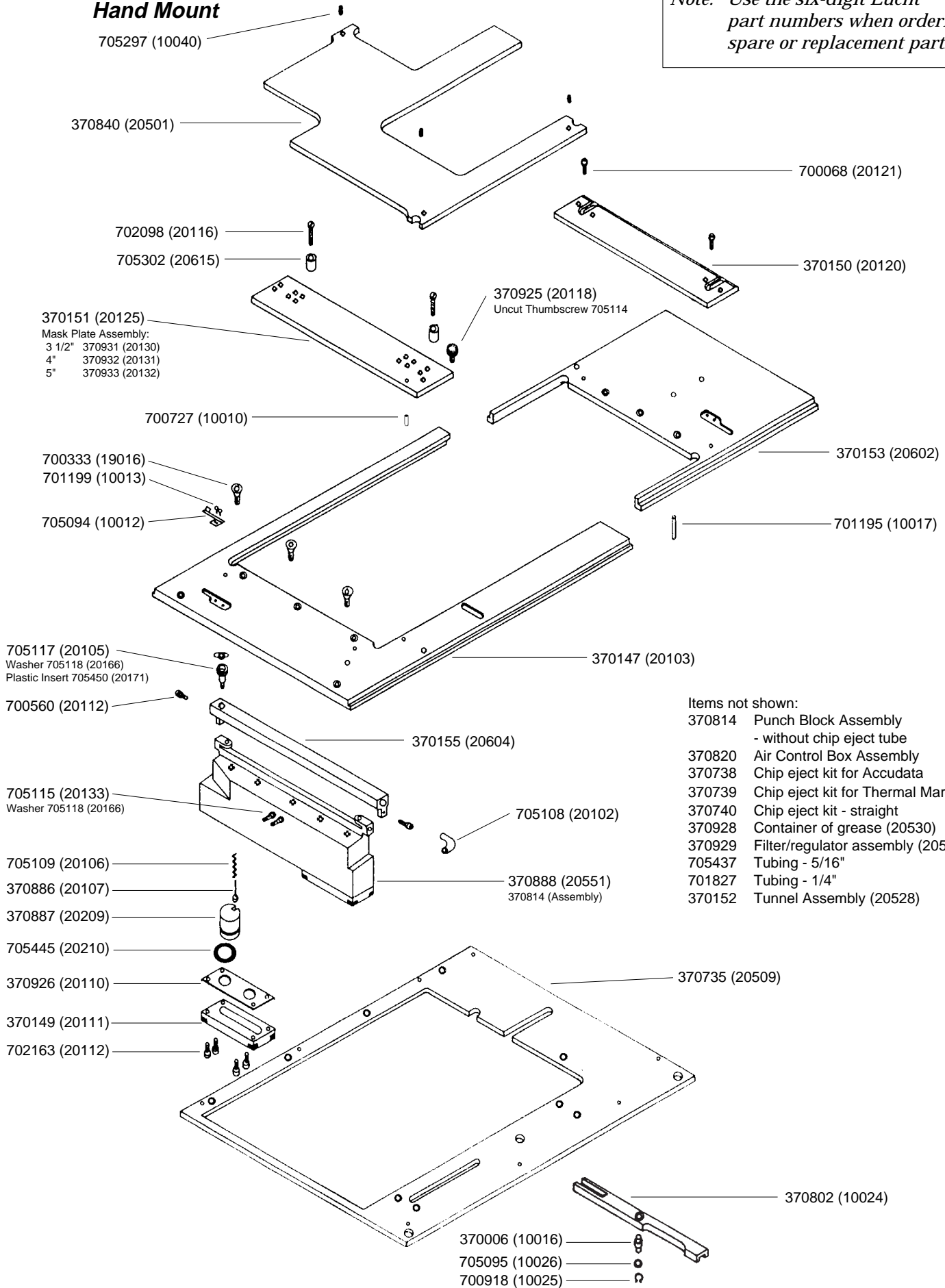

- Items not shown:
- 370814 Punch Block Assembly - without chip eject tube
 - 370820 Air Control Box Assembly
 - 370738 Chip eject kit for Accudata
 - 370739 Chip eject kit for Thermal Marker
 - 370740 Chip eject kit - straight
 - 370928 Container of grease (20530)
 - 370929 Filter/regulator assembly (20531)
 - 705437 Tubing - 5/16"
 - 701827 Tubing - 1/4"
 - 370152 Tunnel Assembly (20528)

370719 / 01-013 5S 5" Punch Marker - Right-Hand

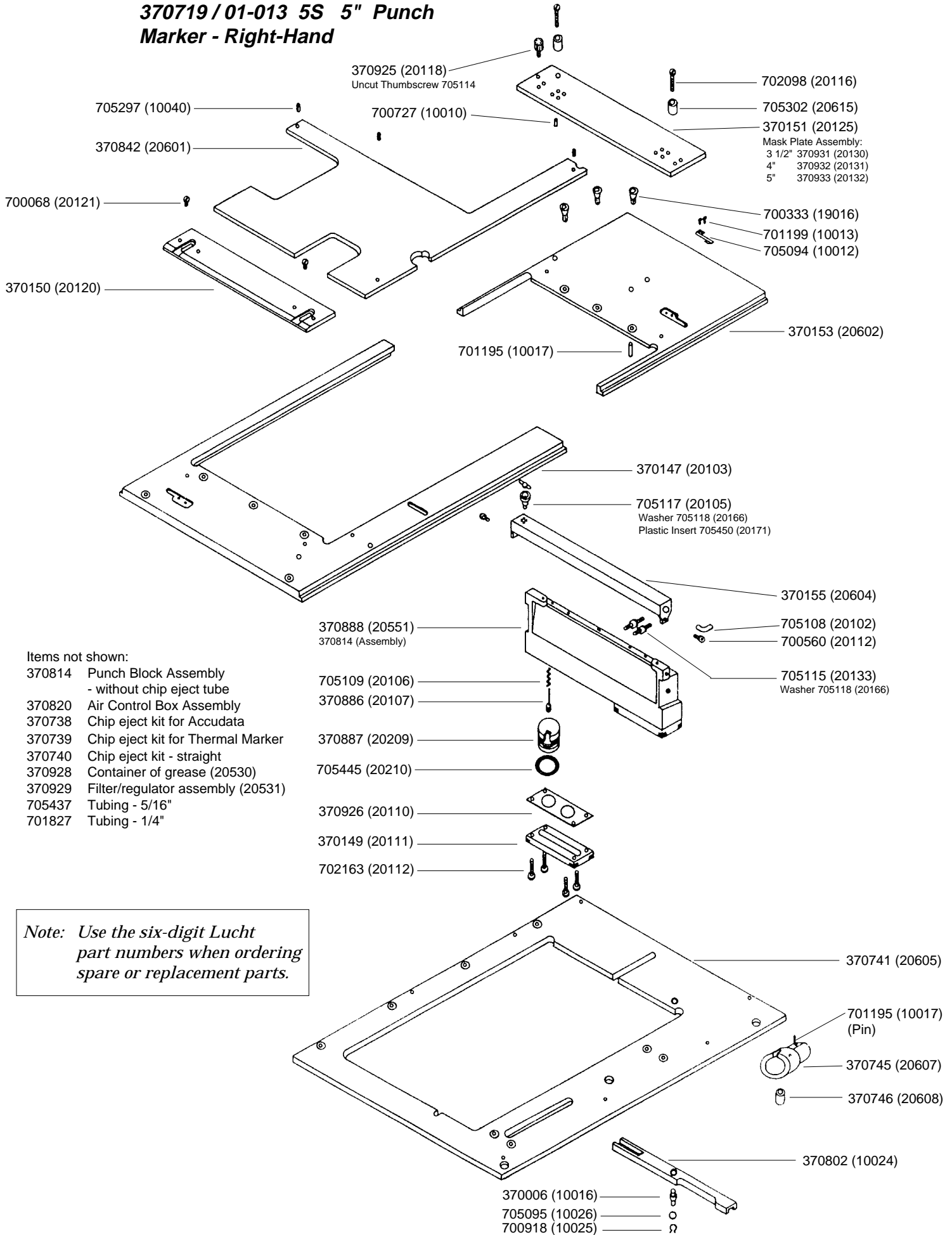

Items not shown:

- 370814 Punch Block Assembly
- without chip eject tube
- 370820 Air Control Box Assembly
- 370738 Chip eject kit for Accudata
- 370739 Chip eject kit for Thermal Marker
- 370740 Chip eject kit - straight
- 370928 Container of grease (20530)
- 370929 Filter/regulator assembly (20531)
- 705437 Tubing - 5/16"
- 701827 Tubing - 1/4"

Note: Use the six-digit Lucht part numbers when ordering spare or replacement parts.

370820 Air Control Box Assembly for 5S Air Punch Markers

Note: Use the six-digit Lucht part numbers when ordering spare or replacement parts.

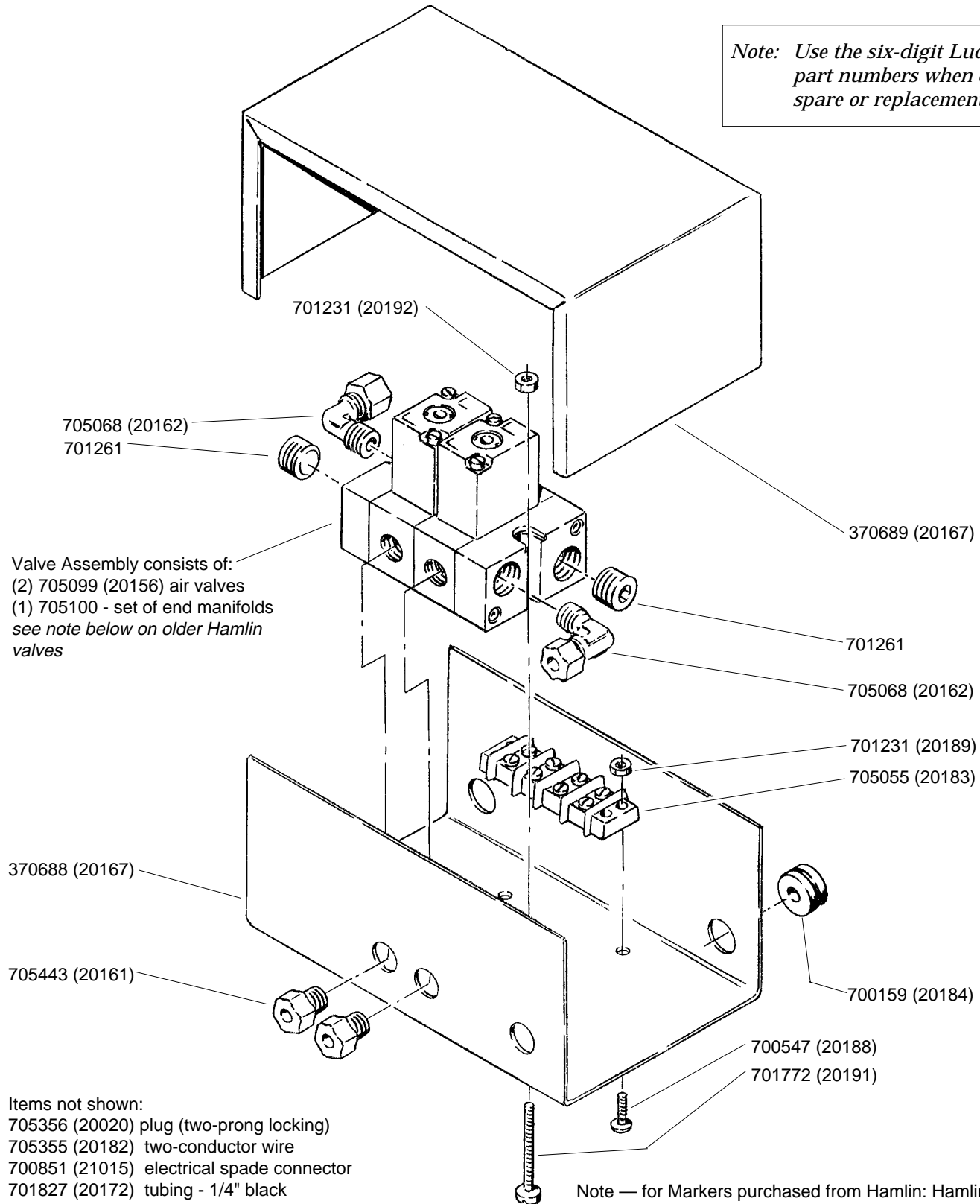

- Filter/regulator assembly - 370929 (20531)
 consists of:
- (1) 700206 filter/regulator
 - (1) 700505 mounting bracket
 - (1) 701008 gauge
 - (1) 705070 1/4" air fitting
 - (1) 705068 1/4" air fitting - elbow

Note — for Markers purchased from Hamlin: Hamlin used three different series of air valves since 1979 when these punches were developed. This style, introduced in 1988, are manufactured by MAC, are blue and black and have the MAC part number of 35ASACDDSA1BA. These parts are not compatible with the brown and black Jucomatic valves, or the older MAC valves (also blue). A complete air control box assembly (370820) must be ordered to replace the older valves.